

**FLOOR 9/PENTHOUSE**

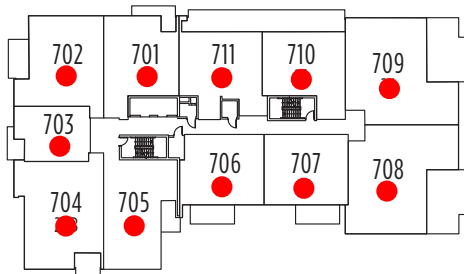

**FLOOR 7**

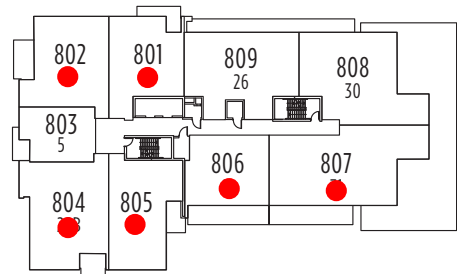

**FLOOR 8**

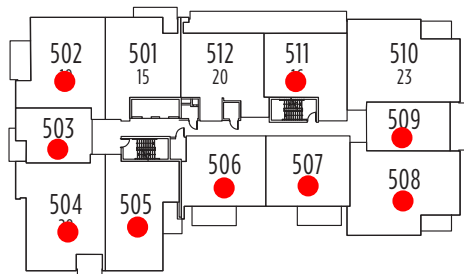

**FLOOR 5**

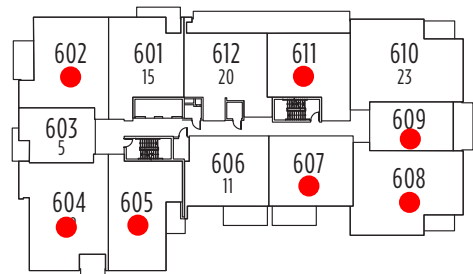

**FLOOR 6**

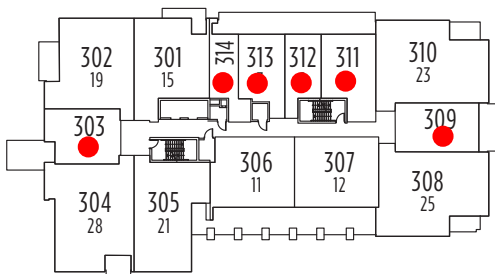

**FLOOR 3**

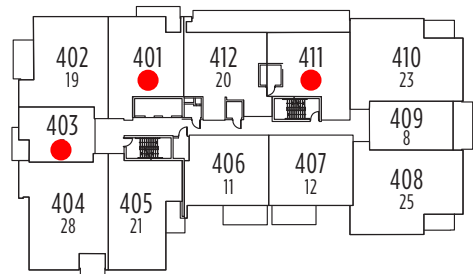

**FLOOR 4**

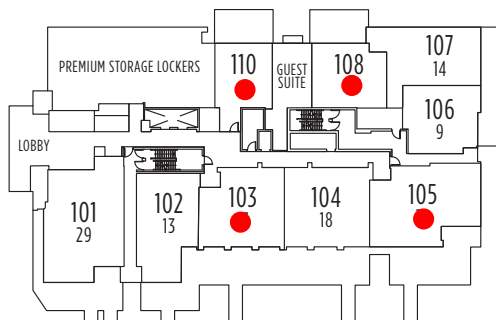

**FLOOR 1**

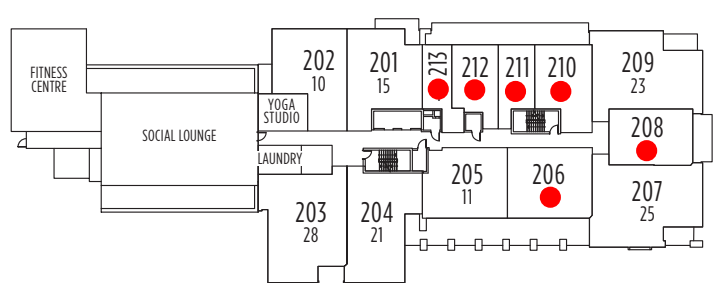

**FLOOR 2**

# River Terraces II Suites

| Model   | Indoor Sq. Ft. | Outdoor Sq. Ft.** | Floors  | Priced From*** |
|---|----------------|-------------------|---------|----------------|
| One Bedroom                                     |                |                   |         |                |
| 5*  | 593            | 105-203           | 6,8     | \$389,900      |
| One Bedroom +                                   |                |                   |         |                |
| 8   | 709            | 140               | 4       | \$479,900      |
| 9   | 752            | 176               | 1       | \$479,900      |
| 10  | 957            | 100               | 2       | \$549,900      |
| Two Bedroom                                     |                |                   |         |                |
| 11  | 880            | 122-321           | 2,3,4,6 | \$569,900      |
| 12  | 897            | 122-324           | 3,4     | \$594,900      |
| 14  | 942            | 150               | 1       | \$559,900      |
| 15  | 954            | 107               | 2,3,5,6 | \$579,900      |
| 17  | 961            | 432               | 1       | \$629,900      |
| 18  | 1081           | 432               | 1       | \$699,900      |
| 19  | 1096           | 132               | 3,4     | \$659,900      |
| Two Bedroom +                                   |                |                   |         |                |
| 20  | 1034           | 258               | 4,5     | \$644,900      |
| 21  | 1097-1119      | 65-74             | 2-4     | \$679,900      |
| 23  | 1217-1224      | 82-92             | 2-6     | \$750,900      |
| 25  | 1276-1305      | 72-84             | 2-4     | \$809,900      |
| 26  | 1280           | 213               | 8       | \$999,900      |
| 28  | 1283           | 107               | 2-4     | \$799,900      |
| 29  | 1324           | 286               | 1       | \$839,900      |
| Penthouse & Select 8 <sup>th</sup> Floor Models |                |                   |         |                |
| 30  | 1388           | 870               | 8       | \$1,349,900    |
| 33  | 1648           | 223               | 9       | \$1,699,900    |
| 36  | 2156           | 281               | 9       | \$2,199,900    |

Sales Consultant  
 Tanya Wehbe  
 613.569.3043  
[twehbe@eqhomes.ca](mailto:twehbe@eqhomes.ca)



Actual usable floor space may vary from stated floor area. All dimensions are subject to normal construction variances. Sizes, pricing and specifications are subject to change without notice. Some features may vary by suite design. \*Parking not available. \*\*The outdoor living square footage varies from floor to floor, please see sales representative. \*\*\*Please see sales representative for detailed pricing sheet. E. & O.E. September 10, 2019.

## **ESTIMATED PROPERTY TAXES:**

1.2%

## **CONDO FEES:**

\$0.49 PER SQ. FT.

Includes: Building insurance. Reserve fund contribution. Upkeep of common areas. Water, Heating / Air Conditioning of common areas. Snow removal and landscaping. Janitorial services. The fees do not include individual unit electricity, water and hydro consumption which will be sub-metered.

## **PARKING:**

Parking is available for \$45,000/Spot

Please note that there is no parking available for Models 16, 32, 33 & 34.

## **STORAGE LOCKER:**

One Storage locker is included in the purchase price.

## **PREMIUM STORAGE LOCKER:**

Premium Storage lockers are available for \*\$13,500/Locker

## **DEPOSIT STRUCTURE:**

15% Total Deposit

1. \$5,000 - At time of signing
- 2: 1/3 - (less initial deposit) 30 days following initial deposit date
- 3: 1/3 - 90 days following date of execution
- 4: 1/3 - 180 days following date of execution
- 5: Balance at closing

All deposits to be made out "Nelligan O'Brien Payne LLP, in Trust"