

MODEL	INDOOR SQ. FT.	OUTDOOR SQ. FT. **	FLOORS	PRICED FROM***
SMART BACHELOR				
3*	514	159	2	\$284,900
ONE BEDROOM				
5*	593	105-203	3-8	\$354,900
ONE BEDROOM +				
8	709	140	4	\$449,900
9	752	176	1	\$424,900
10	957	100	2	\$519,900
TWO BEDROOM				
11	880	122-321	2-6	\$524,900
12	897	122-324	2,3,4,6	\$529,900
14	942	150	1	\$539,900
15	954	107	2,3,5-8	\$549,900
13	941	322	1	\$569,900
16	955	258	4,6	\$569,900
17	961	432	1	\$629,900
19	1096	132	3-8	\$629,900
18	1081	432	1	\$669,900
TWO BEDROOM +				
20	1034	258	4-7	\$609,900
21	1097-1119	65-74	2,3,5,6	\$639,900
23	1217-1224	82-92	2-6	\$700,900
28	1283	107	2,3,4,7	\$749,900
29	1324	286	1	\$759,900
22	1194	504	1	\$789,900
25	1276-1305	72-84	2-5	\$793,900
28B	1344	108	7	\$899,900
26	1280	213	8	\$949,900
PENTHOUSE & SELECT 8TH FLOOR MODELS				
30	1388	870	8	\$1,249,900
33	1648	223	9	\$1,399,900
34	1755	573	9	\$1,499,900
35	1772	414	9	\$1,579,900
36	2156	281	9	\$1,799,900

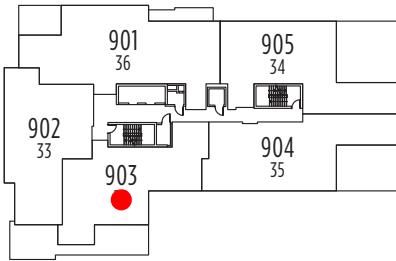

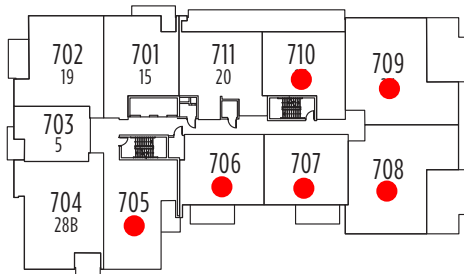

FLOOR 9/PENTHOUSE



FLOOR 7

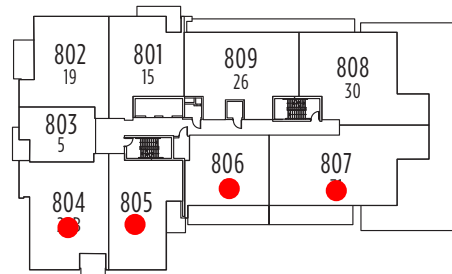

FLOOR 8

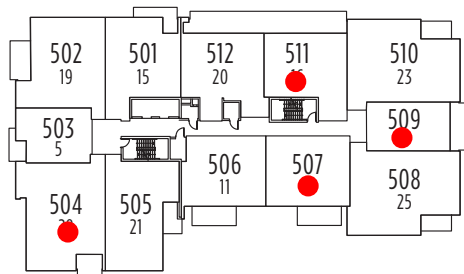

FLOOR 5

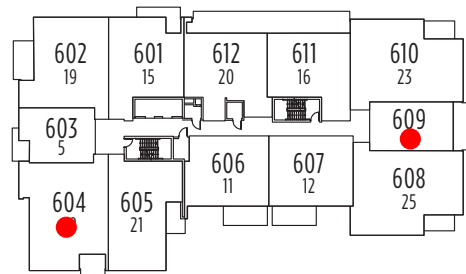

FLOOR 6

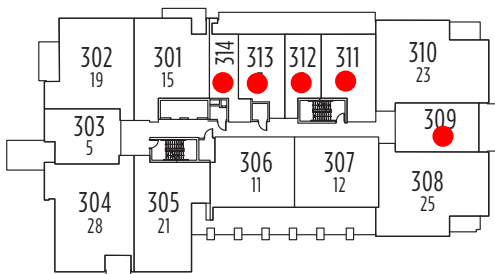

FLOOR 3

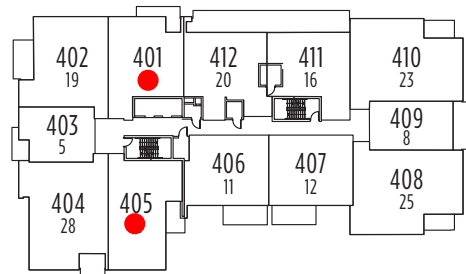

FLOOR 4

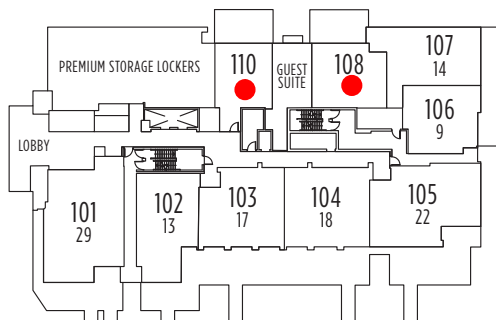

FLOOR 1

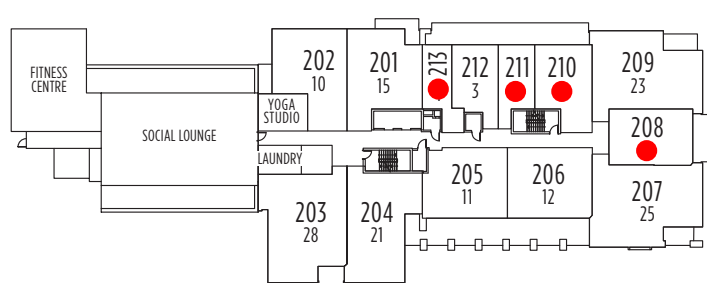

FLOOR 2



ESTIMATED PROPERTY TAXES:

1.2%

CONDO FEES:

\$0.49 PER SQ. FT.

Includes: Building insurance. Reserve fund contribution. Upkeep of common areas. Water, Heating / Air Conditioning of common areas. Snow removal and landscaping. Janitorial services. The fees do not include individual unit electricity, water and hydro consumption which will be sub-metered.

PARKING:

Parking is available for \$39,500 a spot

Please note that there is no parking available for Models 1,2,3,4 & 5

STORAGE LOCKER:

One Storage locker is included in the purchase price.

PREMIUM STORAGE LOCKER:

Premium Storage lockers are available for *\$13,500/locker

DEPOSIT STRUCTURE:

15% Total Deposit

1. \$5,000 - At time of signing
- 2: 1/3 - (less initial deposit) 30 days following initial deposit date
- 3: 1/3 - 90 days following date of execution
- 4: 1/3 - 180 days following date of execution

All deposits to be made out "Nelligan O'Brien Payne LLP, in Trust"

