

THE RIVER

# TERRACES

AT GREYSTONE

NOW UNDER CONSTRUCTION!

FLOOR 9/PENTHOUSE

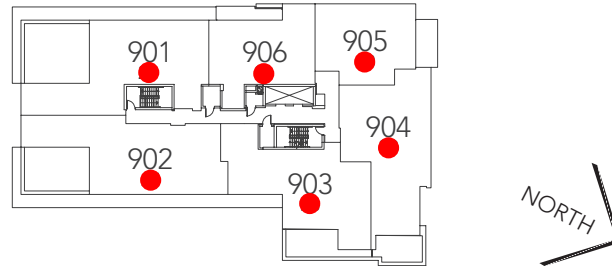

FLOOR 7

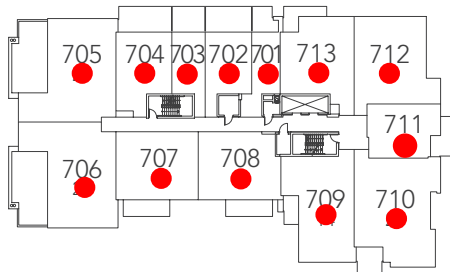

FLOOR 8

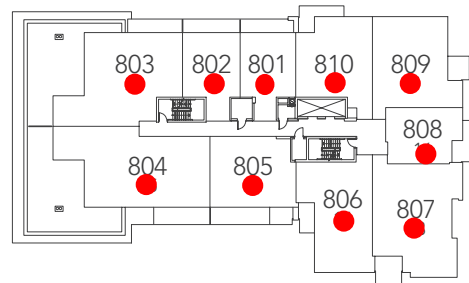

FLOOR 5

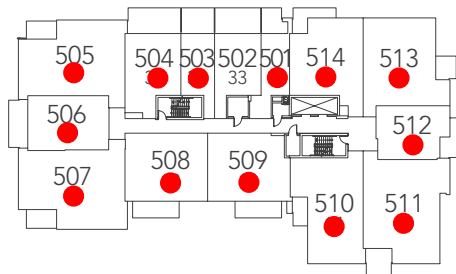

FLOOR 6

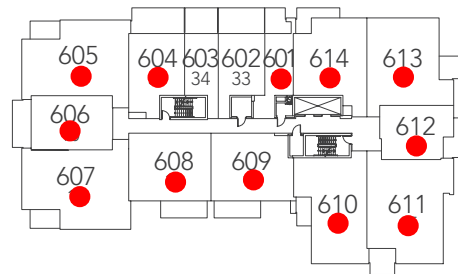

FLOOR 3

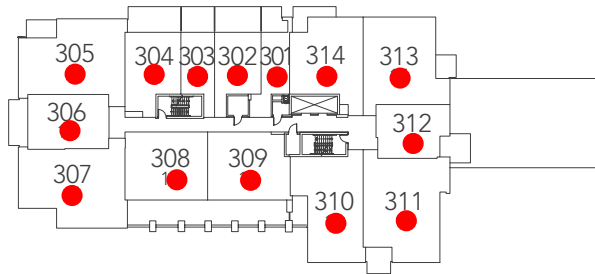

FLOOR 4

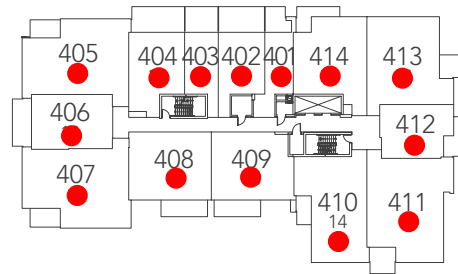

FLOOR 1

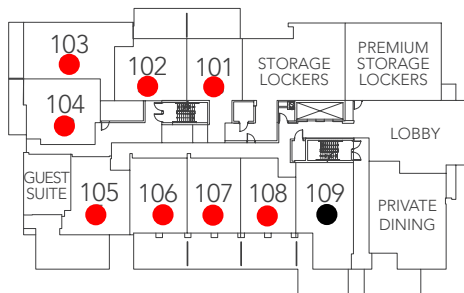

FLOOR 2

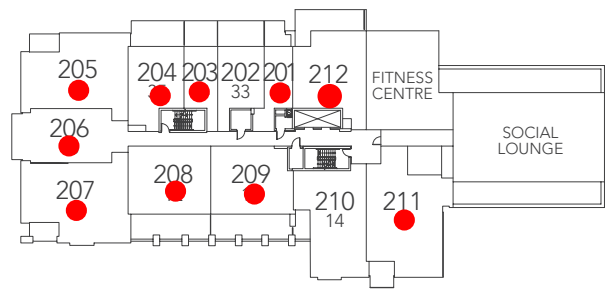

GREYSTONE VILLAGE

A VISIONARY RIVERFRONT COMMUNITY

# River Terraces Designer Finished Homes

Model	Suite	Indoor Sq. Ft.	Outdoor Sq. Ft.**	View	Price***
-------	-------	----------------	-------------------	------	----------

## Smart Bachelor

33*	202	506	152	West	\$297,000
33*	502	506	152	West	\$314,900
33*	602	506	152	West	\$319,900
34*	603	404	122	West	\$275,900

## Two Bedroom + Den

14	210	1097	69	East	\$639,900
----	-----	------	----	------	-----------

Sales Consultant

Tanya Wehbe

613.569.3043

[twehbe@eghomes.ca](mailto:twehbe@eghomes.ca)



Actual usable floor space may vary from stated floor area. All dimensions are subject to normal construction variances. Sizes, pricing and specifications are subject to change without notice. Some features may vary by suite design. \*Parking not available. \*\*The outdoor living square footage varies from floor to floor, please see sales representative. \*\*\*Please see sales representative for detailed pricing sheet. E. & O.E. Aug 6 2019.

**GREYSTONE**  
VILLAGE



## **ESTIMATED PROPERTY TAXES:**

1.2%

## **CONDO FEES:**

\$0.44 PER SQ. FT.

Includes: Building insurance. Reserve fund contribution. Upkeep of common areas. Water, Heating / Air Conditioning of common areas. Snow removal and landscaping. Janitorial services. The fees do not include individual unit electricity, water and hydro consumption which will be sub-metered.

## **PARKING:**

Parking is available for \$45,000/Spot

Please note that there is no parking available for Models 16, 32, 33 & 34.

## **STORAGE LOCKER:**

One Storage locker is included in the purchase price.

## **PREMIUM STORAGE LOCKER:**

Premium Storage lockers are available for \*\$13,500/Locker

## **DEPOSIT STRUCTURE:**

15% Total Deposit

1. \$5,000 - At time of signing
- 2: 1/3 - (less initial deposit) 30 days following initial deposit date
- 3: 1/3 - 60 days following date of execution
- 4: 1/3 - 90 days following date of execution

All deposits to be made out "Nelligan O'Brien Payne LLP, in Trust"