

THE RIVER

# TERRACES

AT GREYSTONE

NOW UNDER CONSTRUCTION!

FLOOR 9/PENTHOUSE

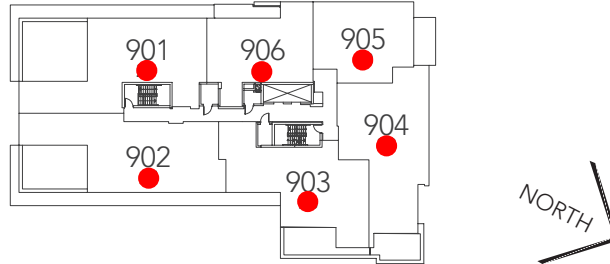

FLOOR 7

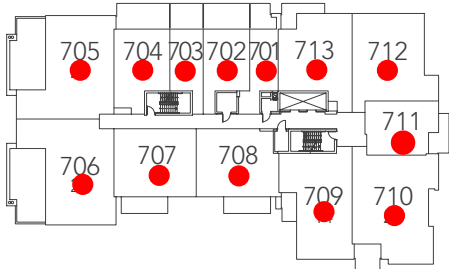

FLOOR 8

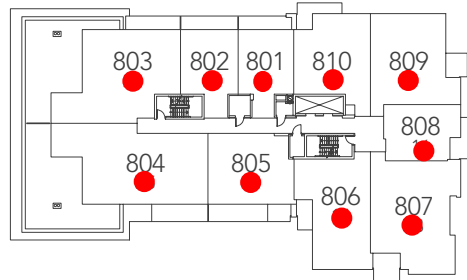

FLOOR 5

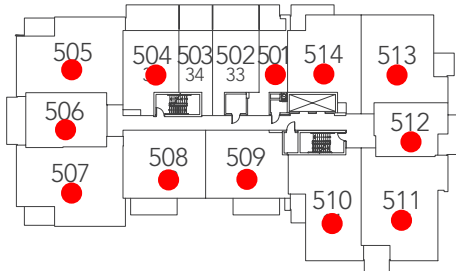

FLOOR 6

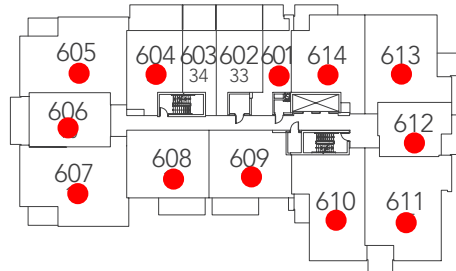

FLOOR 3

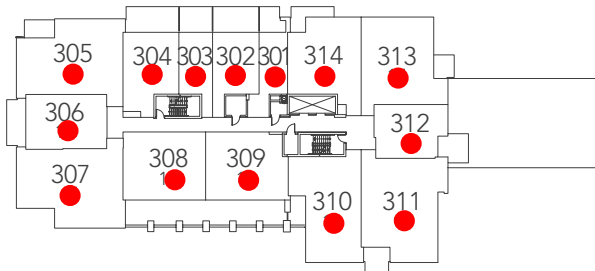

FLOOR 4

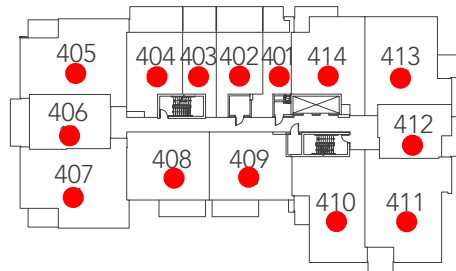

FLOOR 1

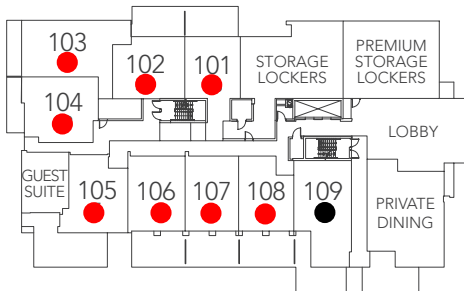

FLOOR 2

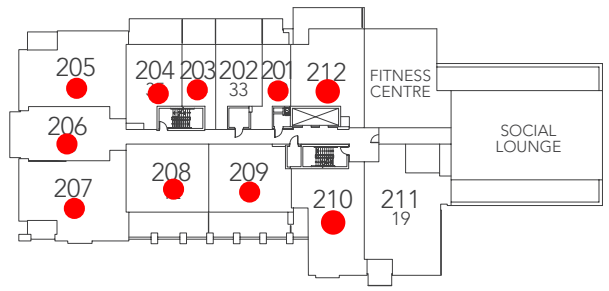

**GREYSTONE**  
VILLAGE

A VISIONARY RIVERFRONT COMMUNITY

**DESIGNER FINISHED HOMES**

Own a new condo styled by our award-winning Design Team. Every Designer Finished suite includes show-stopping features and finishes expertly selected for their timeless beauty.

MODEL	SUITE	INDOOR SQ. FT.	OUTDOOR SQ. FT. **	VIEW	PRICE***
-------	-------	----------------	--------------------	------	----------

SMART BACHELOR					
33*	202	506	152	West	\$287,000
33*	502	506	152	West	\$304,900
33*	602	506	152	West	\$309,900
34*	603	404	122	West	\$265,900
34*	503	404	122	West	\$258,900

ONE BEDROOM + DEN					
1	109	902	322	East	\$477,900

TWO BEDROOM + DEN					
19	211	1379	104	East	\$705,900

Actual usable floor space may vary from stated floor area. All dimensions are subject to normal construction variances. Sizes, pricing and specifications are subject to change without notice. Some features may vary by suite design. \*Parking not available. \*\*The Outdoor living square footage varies from floor to floor, please see sales representative. \*\*\*Please see sales representative for detailed pricing sheet. E. & O. E. February 5, 2019

**MOVE-IN FALL 2019**

**ESTIMATED PROPERTY TAXES:**

1.2%

**CONDO FEES:**

**\$0.44 PER SQ. FT.**

Includes: Building insurance. Reserve fund contribution. Upkeep of common areas. Water, Heating / Air Conditioning of common areas. Snow removal and landscaping. Janitorial services. The fees do not include individual unit electricity, water and hydro consumption which will be sub-metered.

**PARKING:**

Parking is available for \$35,000/Spot

Motorcycle Parking is available for \$15,000/Spot

Please note that there is no parking available for Models 16, 32, 33 & 34.

**STORAGE LOCKER:**

One Storage locker is included in the purchase price.

**PREMIUM STORAGE LOCKER:**

Premium Storage lockers are available for \$10,000+/Locker

**DEPOSIT STRUCTURE:**

F1 % Total Deposit

FEAR EEEAOCa ^A Aa } a \* AA  
 GAFBIAQ •• A aapA^ [ • aDAEAs • A I [ , a \* A aapA^ [ • aAsae AA  
 HAFBIAEAs • A I [ , a \* AaeA A c^ & a } AA  
 I AFBIAEAs • A I [ , a \* AaeA A c^ & a } AA  
 A  
 OHA^ [ • a A A A aA^ v oAa^ | a a A U O : a } A U a } ^ A S U E A A i ~ • a AA

